

THE SITE SOIL CLASSIFICATION HAS BEEN PRESUMED BASED ON A DESK TOP STUDY. CLIENT SHALL REQUEST THE ENGINEER TO INSPECT SITE WHEN CUT PRIOR TO PLACEMENT OF SAND PAD TO VERIFY SOIL CONDITIONS AND DESIGN.

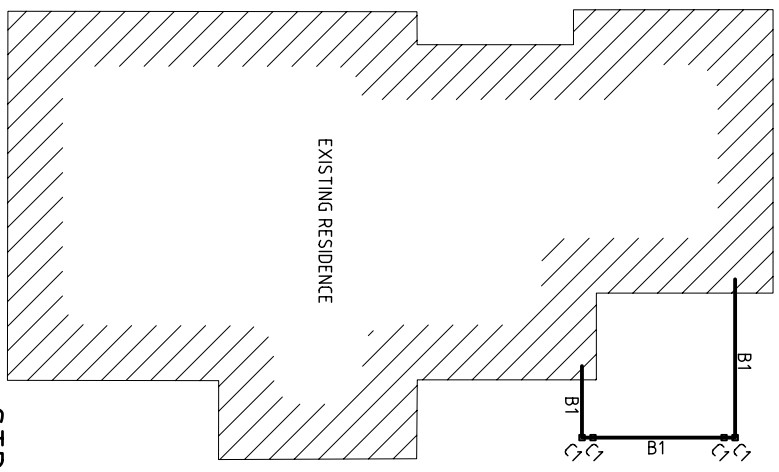

## STRUCTURAL LAYOUT PLAN

SCALE 1:100

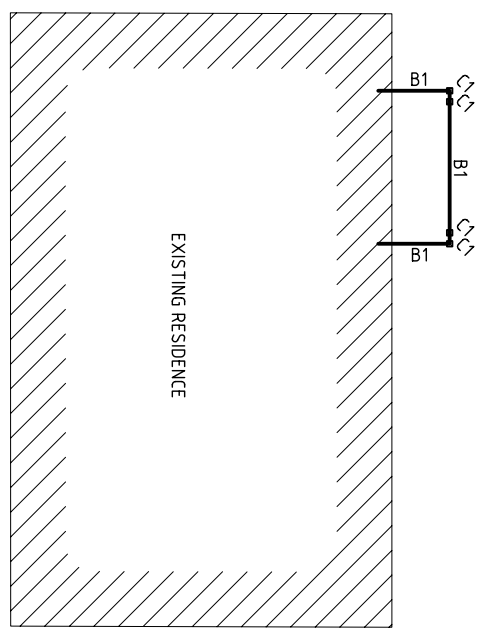

## PROPOSED GABLE COLUMN AND BEAM DETAIL

SCALE 1:20

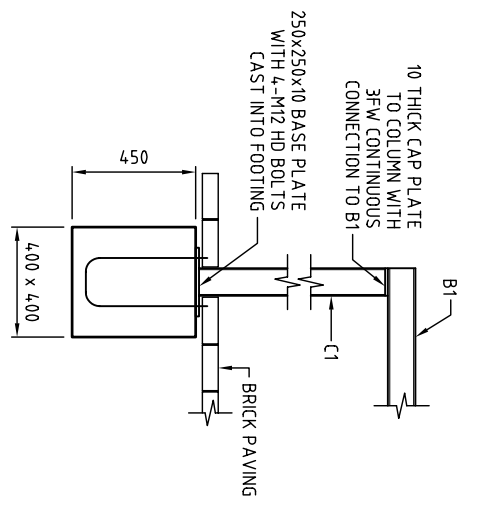

## BASIC DESIGN NOTES AND INFORMATION

- GENERAL**
1. REFER IN CONJUNCTION WITH ARCHITECTURAL DRAWINGS.
  2. BEER ANY DISCREPANCY TO ENGINEER.
  3. CHECK DIMENSIONS, DO NOT SCALE.
  4. INTERNAL WALLS ARE TO HAVE NO POINT LOADS IN EXCESS OF 200kg EACH.
  5. A COPY OF THIS DRAWING IS TO BE ON SITE DURING CONSTRUCTION.
  6. THE LATEST EDITION OF ALL AUSTRALIAN STANDARDS SHALL APPLY.
  7. BUILDER TO COMPLETE ALL TIMBER WORKS ACCORDING TO AS1684, INCLUDING MEMBER CONNECTIONS AND THE DOWN REQUIREMENTS.
  8. ALL CONSTRUCTION TO BE ACCORDING TO THE BCA DERIVED - TO-SATISFY REQUIREMENTS UNO.
- FOUNDATION**
1. THE PROVISIONS OF AS2870 SHALL APPLY.
  2. REMOVE ALL TOP SOIL AND VEGETATION WITHIN THE BUILDING AREA DESIGNED FOR AN ALLOWABLE BEARING OF NOT LESS THAN 100kPa FOR 30 BELOW ALL SLABS AND FOOTINGS.
  3. BUILDER TO BE RESPONSIBLE FOR REMOVAL OF ALL EXISTING FOUNDATION MATERIAL BEFORE PLACING CONCRETE.
  4. BUILDER TO BE RESPONSIBLE FOR REMOVAL OF ALL EXISTING CONCRETE AND GROUND BEING CLASSIFIED AS PER AS2870.
  5. ALL MATERIAL TO BE QUALITY SAND WITH LESS THAN 4% CLAY.
  6. COMPACTED UNIFORMITY TO GIVE STANDARD PERCENT PERCENTAGE READING OF AT LEAST 7 BLOWS/300 BELOW FOUNDATION LEVEL OF FOOTING.
  7. DISPOSE OF ALL STORMWATER AWAY FROM FOOTING.
- CONCRETE**
1. THE PROVISIONS OF AS3600 SHALL APPLY.
  2. ALL CONCRETE COMPRESSIVE STRENGTH AT 28 DAYS SHALL BE:
    - 20MPa FOR RESIDENTIAL GROUND SLABS AND FOOTINGS
 THE CONTRACTOR IS TO SUPPLY EVIDENCE THAT CONCRETE IS OF THE STRENGTH SPECIFIED.
  3. ALL CONCRETE PLACED SHALL HAVE A SLUMP OF BETWEEN 80 AND 50 AND A MINIMUM AGGREGATE SIZE OF 20 MAX.
  4. ALL CONCRETE TO BE PLACED WITH AN APPROVED VIBRATOR.
  5. ALL CONCRETE MUST BE CURED BY KEEPING EXPOSED SURFACES CONTINUALLY WET FOR 7 DAYS AFTER POURING OR EQUIVALENT CURING METHODS.
  6. ALL JOINTS AND PIPES SHALL BE TAKEN BELOW FINISH FOOTINGS ARE STEPPED AROUND DUCTS AS DIRECTED BY ENGINEER.
  7. COVER TO REINFORCING SHALL BE:
 

INTERNAL	20	EXTERNAL	40
----------	----	----------	----
- SLABS**
1. FOOTINGS ON GROUND: 50
  2. IF CONSTRUCTION IS WITHIN 4m OF LARGE EXPANSION OF SALT WATER AND THE COAST LINE THEN INCREASE THE CONCRETE STRENGTH TO 40MPa AND INCREASE THE EXTERNAL COVER BY 10.
  3. CONDUITS AND PIPES SHALL HAVE 25 COVER AND BE LOCATED ABOVE BOTTOM REINFORCEMENT AND BELOW TOP REINFORCEMENT.
  4. MINIMUM STRIPPING TIME SHALL BE 14 DAYS FOR SLABS AND BEAM SOFFITS.

### REINFORCEMENT

1. THE PROVISIONS OF AS4671 SHALL APPLY.
2. ALL REINFORCING TO BE DEFORMED BARS GRADE 500, WITH DUCTILITY CLASS L.
3. FOR MESH AND N FOR BARS.
4. ALL REINFORCEMENT SHALL BE CLEAN AND FREE FROM RUST, SCALE OR OIL AND OTHER POLLUTANTS.
5. REINFORCING SHALL HAVE MIN. SIDE AND ENDLAPS OF 2 CROSS WIRES FROM BOTH ENDS.
6. ALL REINFORCING IS TO BE ACCURATELY POSITIONED AS DIRECTED ON DRAWINGS AND SUPPORTED ON APPROVED CHAIRS AND WEDGES AT INTERSECTIONS.
7. TWO STRIPS 2000 IN LENGTH OF 3-SL87M, ONE STRIP OF 3-SL117M OR 3-M12 BARS SHALL BE PLACED DIAGONALLY ACROSS A POTENTIAL CRACK AT RE-ENTRANT CORNERS OF ALL SLABS.
8. MESH REINFORCEMENT MUST BE UNDEFORMED FLAT SHEETS (NOT ROLLS).
9. BARS TO HAVE MINIMUM LAPS OF 40 x DIAMETER.

MEMBER SCHEDULE	
C1	100x100x3 SHS COLUMN
B1	125 PFC BEAM

REVISION	DESCRIPTION	TK	JC	ME	DATE
A	INITIAL DRAWING				JAN 06

**McDowall Affleck**

DESIGNERS | PROJECT MANAGERS | CONSTRUCTORS

69 Great Northern Hwy Midland  
Western Australia 6056  
PO Box 1377 Midland WA 6936

T +61 8 9274 6444 F +61 8 9250 3433  
E manage@mcdownall-affleck.com.au  
www.mcdownallaffleck.com.au

THIS IS ISSUED FOR INFORMATION COMMENT APPROVAL TENDER CONSTRUCTION

DO NOT USE FOR ANY PURPOSE OTHER THAN THAT INDICATED

SCALE: AS SHOWN

SHEET SIZE: A3

DATE: -

ALL DIMENSIONS IN MILLIMETRES DO NOT SCALE

CLIENT: PROPOSED ADDITIONS LOT 274 CHARLES STREET MIDLAND

**DHW EHZ MPM**

TITLE: STRUCTURAL LAYOUT PLAN & DETAIL

DRAWING NUMBER: 10244-01

REVISION: A